

SAFN2
(SA2-Fitted)

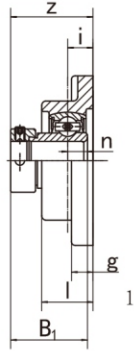

SAFN2

Flange Unit
(Light duty)

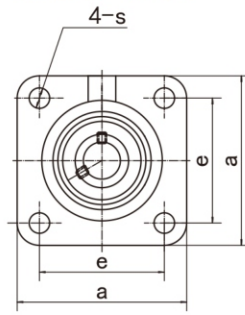

SBFN2
(SB2-Fitted)

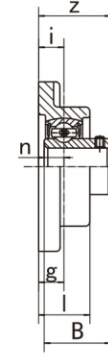

SBFN2

Unit NO.	Dimensions (mm / in.)										Bolt Size mm/in.	Bearing No.	Housing No.	Weight (kg)											
	d	a	e	i	g	s	l	z	B ₁	n															
SAFN 201 201-8	12 1/2	76	54	11.4	9.5	11	18	33.5	28.6	6.5	M10	SA201	FN201	0.40											
SAFN 202 202-9 202-10	15 9/16 5/8											3			2-1/8	0.448	3/8	7/16	23/32	1.319	1.1260	0.2559	3/8	SA202 SA202-9 SA202-10	FN202
SAFN 203 203-11	17 11/16											SA203 SA203-11			FN203										
SAFN 204 204-12	20 3/4	86 3-3/8	63.5 2-1/2	12.6 0.495	11 7/16	11 7/16	20.5 13/16	36.1 1.421	31 1.2204	7.5 0.2953	M10 5/16	SA204 SA204-12	FN204	0.64											
SAFN 205 205-13 205-14 205-15 205-16	25 13/16 7/8 15/16 1	95 3-3/4	70 2-3/4	12.3 0.483	11 7/16	13 33/64	20.5 13/16	35.8 1.409	31 1.2204	7.5 0.2953	M12 7/16	SA205 SA205-13 SA205-14 SA205-15 SA205-16	FN205	0.77											
SAFN 206 206-17 206-18 206-19 206-20	30 1-1/16 1-1/8 1-3/16 1-1/4	108 4-1/4	82.5 3-1/4	12.1 0.478	13.5 17/32	13 33/64	24 61/64	38.8 1.527	35.7 1.4055	9 0.3543	M12 7/16	SA206 SA206-17 SA206-18 SA206-19 SA206-20	FN206	1.14											
SAFN 207 207-20 207-21 207-22 207-23	35 1-1/4 1-5/16 1/3/8 1-7/16	117 4-5/8	92 3-5/8	14.6 0.575	15 19/32	14 35/64	26.5 1-3/64	44 1.732	38.9 1.5315	9.5 0.3740	M12 1/2	SA207 SA207-20 SA207-21 SA207-22 SA207-23	FN207	1.58											
SAFN 208 208-24 208-25	40 1-1/2 1-9/16	130 5-1/8	101.5 4	15.5 0.610	16 5/8	14 35/64	28.5 1-1/8	48.2 1.898	43.7 1.7205	11 0.4331	M12 1/2	SA208 SA208-24 SA208-25	FN208	2.05											
SAFN 209 209-26 209-27 209-28	45 1-5/8 1-11/16 1-3/4	136 5-3/8	105 4-1/8	13.8 0.544	16 5/8	16 5/8	28.5 1-1/8	46.5 1.831	43.7 1.7205	11 0.4331	M14 9/16	SA209 SA209-26 SA209-27 SA209-28	FN209	2.19											

Unit NO.	Dimensions (mm / in.)										Bolt Size mm/in.	Bearing No.	Housing No.	Weight (kg)											
	d	a	e	i	g	s	l	z	B	n															
SBFN 201 201-8	12 1/2	76	54	11.4	9.5	11	18	27.4	22	6	M10	SB201	FN201	0.38											
SBFN 202 202-9 202-10	15 9/16 5/8											3			2-1/8	0.448	3/8	7/16	23/32	1.079	0.8661	0.2362	3/8	SB202 SB202-9 SB202-10	FN202
SBFN 203 203-11	17 11/16											SB203 SB203-11			FN203										
SBFN 204 204-12	20 3/4	86 3-3/8	63.5 2-1/2	12.6 0.495	11 7/16	11 7/16	20.5 13/16	30.6 1.205	25 0.9843	7 0.2756	M10 5/16	SB204 SB204-12	FN204	0.60											
SBFN 205 205-13 205-14 205-15 205-16	25 13/16 7/8 15/16 1	95 3-3/4	70 2-3/4	12.3 0.483	11 7/16	13 33/64	20.5 13/16	31.8 1.252	27 1.0630	7.5 0.2953	M12 7/16	SB205 SB205-13 SB205-14 SB205-15 SB205-16	FN205	0.74											
SBFN 206 206-17 206-18 206-19 206-20	30 1-1/16 1-1/8 1-3/16 1-1/4	108 4-1/4	82.5 3-1/4	12.1 0.478	13.5 17/32	13 33/64	24 61/64	34.1 1.342	30 1.1811	8 0.3150	M12 7/16	SB206 SB206-17 SB206-18 SB206-19 SB206-20	FN206	1.10											
SBFN 207 207-20 207-21 207-22 207-23	35 1-1/4 1-5/16 1/3/8 1-7/16	117 4-5/8	92 3-5/8	14.6 0.575	15 19/32	14 35/64	26.5 1-3/64	38.1 1.500	32 1.2598	8.5 0.3364	M12 1/2	SB207 SB207-20 SB207-21 SB207-22 SB207-23	FN207	1.45											
SBFN 208 208-24 208-25	40 1-1/2 1-9/16	130 5-1/8	101.5 4	15.5 0.610	16 5/8	14 35/64	28.5 1-1/8	40.5 1.594	34 1.3386	9 0.3543	M12 1/2	SB208 SB208-24 SB208-25	FN208	1.90											
SBFN 209 209-26 209-27 209-28	45 1-5/8 1-11/16 1-3/4	136 5-3/8	105 4-1/8	13.8 0.544	16 5/8	16 5/8	28.5 1-1/8	44.8 1.764	41.2 1.6220	10.2 0.402	M14 9/16	SB209 SB209-26 SB209-27 SB209-28	FN209	2.09											

Note: To specify relubricatable units, add "G" suffix, (e.g., SBFN205-16G)