

SAFTN2
(SA2-Fitted)

Flange Unit
(Light duty)

SBFTN2
(SB2-Fitted)

SAFTN2

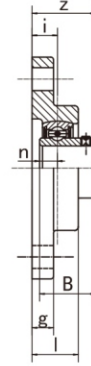
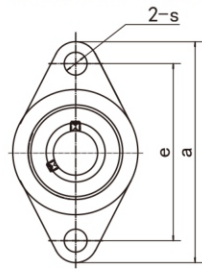
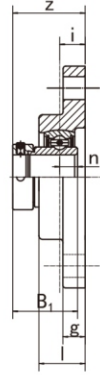

SBFTN2

Unit NO.	Dimensions (mm / in.)										Bolt Size mm/in.	Bearing No.	Housing No.	Weight (kg)
	d	a	e	i	g	l	s	z	B ₁	n				
SAFTN 201 201-8	12 1/2	98 3-7/8	76.2 3	11.4 0.448	9.5 3/8	18 23/32	11 7/16	33.5 1.319	28.6 1.1260	6.5 0.2559	M10 3/8	SA201	FTN201	0.29
SAFTN 202 202-9 202-10	15 9/16 5/8											SA201-8		
SAFTN 203 203-11	17 11/16											SA202		
SAFTN 204 204-12	20 3/4	112 4-13/32	90 3-17/32	12.6 0.495	11 7/16	20.5 13/16	11 7/16	36.1 1.421	31 1.2204	7.5 0.2953	M10 5/16	SA202-9 SA202-10	FTN202	0.46
SAFTN 205 205-13 205-13 205-13	25 13/16 7/8 15/16 1	124 4-7/8	99 3-57/64	12.3 0.483	11 7/16	20.5 13/16	13 33/64	35.8 1.409	31 1.2204	7.5 0.2953	M12 7/16	SA203	FTN203	
SAFTN 206 206-17 206-18 206-19 206-20	30 1-1/16 1-1/8 1-3/16 1-1/4	141 5-9/16	116.5 4-19/32	12.1 0.478	13 33/64	24 61/64	13 33/64	38.8 1.527	35.7 1.4055	9 0.3543	M12 7/16	SA204	FTN204	
SAFTN 207 207-20 207-21 207-22 207-23	35 1-1/4 1-5/16 1/3/8 1-7/16	155 6-1/6	130 5-1/8	14.6 0.575	15 19/32	26.5 1-3/64	14 35/64	44 1.732	38.9 1.5315	9.5 0.3740	M12 1/2	SA205	FTN205	0.56
SAFTN 208 208-24 208-25	40 1-1/2 1-9/16	171 6-3/4	143.5 5-21/32	15.5 0.610	16 5/8	28.5 1-1/8	14 35/64	48.2 1.898	43.7 1.7205	11 0.4331	M12 1/2	SA205-13 SA205-14 SA205-15 SA205-16	FTN206	
SAFTN 209 209-26 209-27 209-28	45 1-5/8 1-11/16 1-3/4	179 7-1/16	148.5 5-27/32	13.8 0.544	16 5/8	28.5 1-1/8	16 5/8	46.5 1.831	43.7 1.7205	11 0.4331	M14 9/16	SA206	FTN206	
SAFTN 207 207-20 207-21 207-22 207-23	35 1-1/4 1-5/16 1/3/8 1-7/16	155 6-1/6	130 5-1/8	14.6 0.575	15 19/32	26.5 1-3/64	14 35/64	44 1.732	38.9 1.5315	9.5 0.3740	M12 1/2	SA206-17 SA206-18 SA206-19 SA206-20	FTN207	1.16
SAFTN 208 208-24 208-25	40 1-1/2 1-9/16	171 6-3/4	143.5 5-21/32	15.5 0.610	16 5/8	28.5 1-1/8	14 35/64	48.2 1.898	43.7 1.7205	11 0.4331	M12 1/2	SA207	FTN207	
SAFTN 209 209-26 209-27 209-28	45 1-5/8 1-11/16 1-3/4	179 7-1/16	148.5 5-27/32	13.8 0.544	16 5/8	28.5 1-1/8	16 5/8	46.5 1.831	43.7 1.7205	11 0.4331	M14 9/16	SA207-20 SA207-21 SA207-22 SA207-23	FTN208	
SBFTN 201 201-8	12 1/2	98 3-7/8	76.2 3	11.4 0.448	9.5 3/8	18 23/32	11 7/16	27.4 1.079	22 0.8661	6 0.2362	M10 3/8	SB201	FTN201	0.26
SBFTN 202 202-9 202-10	15 9/16 5/8											SB201-8		
SBFTN 203 203-11	17 11/16											SB202		
SBFTN 204 204-12	20 3/4	112 4-13/32	90 3-17/32	12.6 0.495	11 7/16	20.5 13/16	11 7/16	30.6 1.205	25 0.9843	7 0.2756	M10 5/16	SB202-9 SB202-10	FTN202	0.43
SBFTN 205 205-13 205-13 205-13	25 13/16 7/8 15/16 1	124 4-7/8	99 3-57/64	12.3 0.483	11 7/16	20.5 13/16	13 33/64	31.8 1.252	27 1.0630	7.5 0.2953	M12 7/16	SB203	FTN203	
SBFTN 206 206-17 206-18 206-19 206-20	30 1-1/16 1-1/8 1-3/16 1-1/4	141 5-9/16	116.5 4-19/32	12.1 0.478	13 33/64	24 61/64	13 33/64	34.1 1.342	30 1.1811	8 0.3150	M12 7/16	SB204	FTN204	
SBFTN 207 207-20 207-21 207-22 207-23	35 1-1/4 1-5/16 1/3/8 1-7/16	155 6-1/6	130 5-1/8	14.6 0.575	15 19/32	26.5 1-3/64	14 35/64	38.1 1.500	32 1.2598	8.5 0.3364	M12 1/2	SB205	FTN205	0.52
SBFTN 208 208-24 208-25	40 1-1/2 1-9/16	171 6-3/4	143.5 5-21/32	15.5 0.610	16 5/8	28.5 1-1/8	14 35/64	40.5 1.594	34 1.3386	9 0.3543	M12 1/2	SB205-13 SB205-14 SB205-15 SB205-16	FTN206	
SBFTN 209 209-26 209-27 209-28	45 1-5/8 1-11/16 1-3/4	179 7-1/16	148.5 5-27/32	13.8 0.544	16 5/8	28.5 1-1/8	16 5/8	44.8 1.764	41.2 1.6220	10.2 0.402	M14 9/16	SB206	FTN206	
SBFTN 207 207-20 207-21 207-22 207-23	35 1-1/4 1-5/16 1/3/8 1-7/16	155 6-1/6	130 5-1/8	14.6 0.575	15 19/32	26.5 1-3/64	14 35/64	38.1 1.500	32 1.2598	8.5 0.3364	M12 1/2	SB207	FTN207	1.03
SBFTN 208 208-24 208-25	40 1-1/2 1-9/16	171 6-3/4	143.5 5-21/32	15.5 0.610	16 5/8	28.5 1-1/8	14 35/64	40.5 1.594	34 1.3386	9 0.3543	M12 1/2	SB207-20 SB207-21 SB207-22 SB207-23	FTN208	
SBFTN 209 209-26 209-27 209-28	45 1-5/8 1-11/16 1-3/4	179 7-1/16	148.5 5-27/32	13.8 0.544	16 5/8	28.5 1-1/8	16 5/8	44.8 1.764	41.2 1.6220	10.2 0.402	M14 9/16	SB208	FTN208	
SBFTN 209 209-26 209-27 209-28	45 1-5/8 1-11/16 1-3/4	179 7-1/16	148.5 5-27/32	13.8 0.544	16 5/8	28.5 1-1/8	16 5/8	44.8 1.764	41.2 1.6220	10.2 0.402	M14 9/16	SB209	FTN209	1.61
SBFTN 208 208-24 208-25	40 1-1/2 1-9/16	171 6-3/4	143.5 5-21/32	15.5 0.610	16 5/8	28.5 1-1/8	14 35/64	40.5 1.594	34 1.3386	9 0.3543	M12 1/2	SB209-26 SB209-27 SB209-28	FTN209	
SBFTN 207 207-20 207-21 207-22 207-23	35 1-1/4 1-5/16 1/3/8 1-7/16	155 6-1/6	130 5-1/8	14.6 0.575	15 19/32	26.5 1-3/64	14 35/64	38.1 1.500	32 1.2598	8.5 0.3364	M12 1/2	SB209-26 SB209-27 SB209-28	FTN209	

Unit NO.	Dimensions (mm / in.)										Bolt Size mm/in.	Bearing No.	Housing No.	Weight (kg)
	d	a	e	i	g	l	s	z	B	n				
SBFTN 201 201-8	12 1/2	98 3-7/8	76.2 3	11.4 0.448	9.5 3/8	18 23/32	11 7/16	27.4 1.079	22 0.8661	6 0.2362	M10 3/8	SB201	FTN201	0.26
SBFTN 202 202-9 202-10	15 9/16 5/8											SB201-8		
SBFTN 203 203-11	17 11/16											SB202		
SBFTN 204 204-12	20 3/4	112 4-13/32	90 3-17/32	12.6 0.495	11 7/16	20.5 13/16	11 7/16	30.6 1.205	25 0.9843	7 0.2756	M10 5/16	SB202-9 SB202-10	FTN202	0.43
SBFTN 205 205-13 205-13 205-13	25 13/16 7/8 15/16 1	124 4-7/8	99 3-57/64	12.3 0.483	11 7/16	20.5 13/16	13 33/64	31.8 1.252	27 1.0630	7.5 0.2953	M12 7/16	SB203	FTN203	
SBFTN 206 206-17 206-18 206-19 206-20	30 1-1/16 1-1/8 1-3/16 1-1/4	141 5-9/16	116.5 4-19/32	12.1 0.478	13 33/64	24 61/64	13 33/64	34.1 1.342	30 1.1811	8 0.3150	M12 7/16	SB204	FTN204	
SBFTN 207 207-20 207-21 207-22 207-23	35 1-1/4 1-5/16 1/3/8 1-7/16	155 6-1/6	130 5-1/8	14.6 0.575	15 19/32	26.5 1-3/64	14 35/64	38.1 1.500	32 1.2598	8.5 0.3364	M12 1/2	SB205	FTN205	0.52
SBFTN 208 208-24 208-25	40 1-1/2 1-9/16	171 6-3/4	143.5 5-21/32	15.5 0.610	16 5/8	28.5 1-1/8	14 35/64	40.5 1.594	34 1.3386	9 0.3543	M12 1/2	SB205-13 SB205-14 SB205-15 SB205-16	FTN206	
SBFTN 209 209-26 209-27 209-28	45 1-5/8 1-11/16 1-3/4	179 7-1/16	148.5 5-27/32	13.8 0.544	16 5/8	28.5 1-1/8	16 5/8	44.8 1.764	41.2 1.6220	10.2 0.402	M14 9/16	SB206	FTN206	
SBFTN 207 207-20 207-21 207-22 207-23	35 1-1/4 1-5/16 1/3/8 1-7/16	155 6-1/6	130 5-1/8	14.6 0.575	15 19/32	26.5 1-3/64	14 35/64	38.1 1.500	32 1.2598	8.5 0.3364	M12 1/2	SB207	FTN207	1.03
SBFTN 208 208-24 208-25	40 1-1/2 1-9/16	171 6-3/4	143.5 5-21/32	15.5 0.610	16 5/8	28.5 1-1/8	14 35/64	40.5 1.594	34 1.3386	9 0.3543	M12 1/2	SB207-20 SB207-21 SB207-22 SB207-23	FTN208	
SBFTN 209 209-26 209-27 209-28	45 1-5/8 1-11/16 1-3/4	179 7-1/16	148.5 5-27/32	13.8 0.544	16 5/8	28.5 1-1/8	16 5/8	44.8 1.764	41.2 1.6220	10.2 0.402	M14 9/16	SB208	FTN208	
SBFTN 209 209-26 209-27 209-28	45 1-5/8 1-11/16 1-3/4	179 7-1/16	148.5 5-27/32	13.8 0.544	16 5/8	28.5 1-1/8	16 5/8	44.8 1.764	41.2 1.6220	10.2 0.402	M14 9/16	SB209	FTN209	1.61
SBFTN 208 208-24 208-25	40 1-1/2 1-9/16	171 6-3/4	143.5 5-21/32	15.5 0.610	16 5/8	28.5 1-1/8	14 35/64	40.5 1.594	34 1.3386	9 0.3543	M12 1/2	SB209-26 SB209-27 SB209-28	FTN209	
SBFTN 207 207-20 207-21 207-22 207-23	35 1-1/4 1-5/16 1/3/8 1-7/16	155 6-1/6	130 5-1/8	14.6 0.575	15 19/32	26.5 1-3/64	14 35/64	38.1 1.500	32 1.2598	8.5 0.3364	M12 1/2	SB209-26 SB209-27 SB209-28	FTN209	

Note: To specify relubricatable units, add "G" suffix, (e.g., SBFTN205-16G)